

Left Side Plate:1 Pc

Right Side Plate:1 Pc

Door Frame:1 Pc

Back Plate:1 Pc

Top Plate:1 Pc

Middle Plate:1 Pc

Hanging Rod:
Left(Short):2 Pcs
Right(Long):2 Pcs

Upper Division
Plate(Small):1 Pc

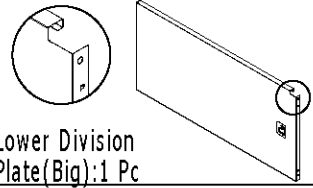
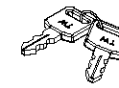
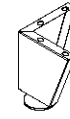
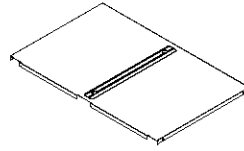

Bottom Plate:1 Pc

Standing Feet:4 Pcs

Self-tapping
Screw(5x12):30 Pcs

Key:4 Sets

Lower Division
Plate(Big):1 Pc

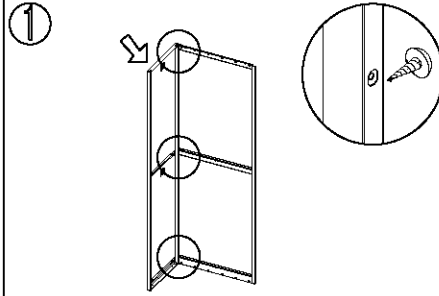
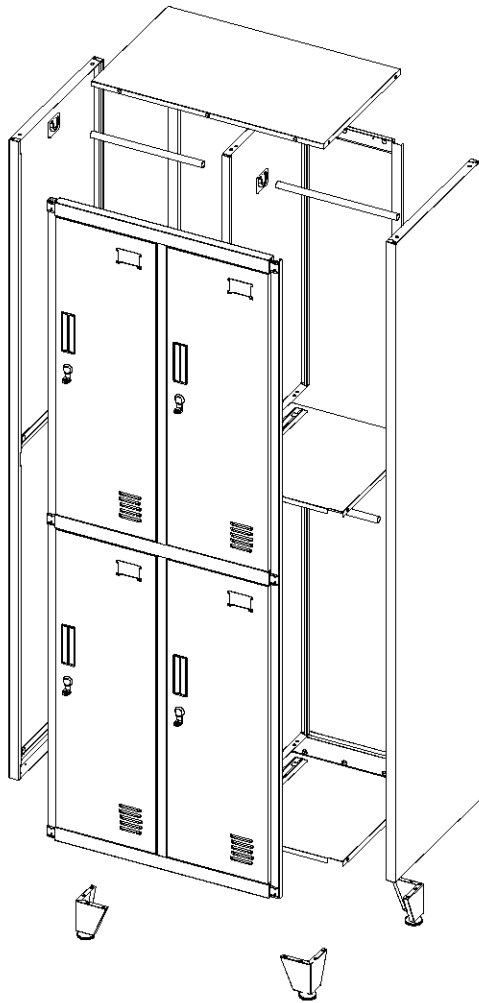

1 Connect the left side plate with back plate by self-tapping screws(5x12).

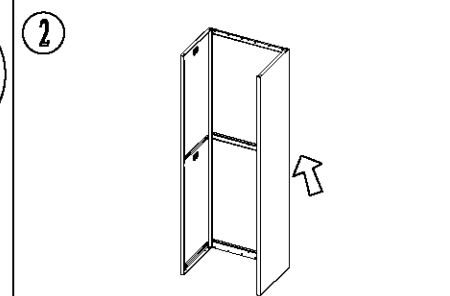

2 Connect the right side plate with back plate.

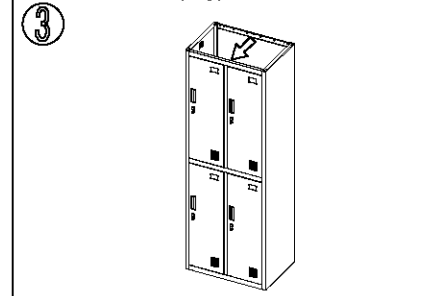

3 Fix the door frame onto both of the side plates.

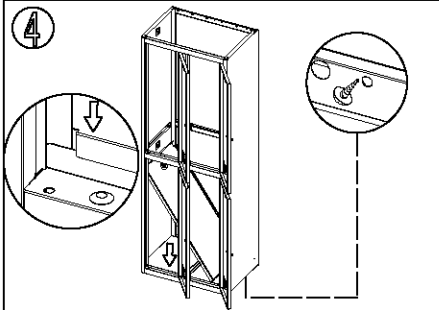

4 Install the bottom plate firstly, and put the lower division plate into the locker.

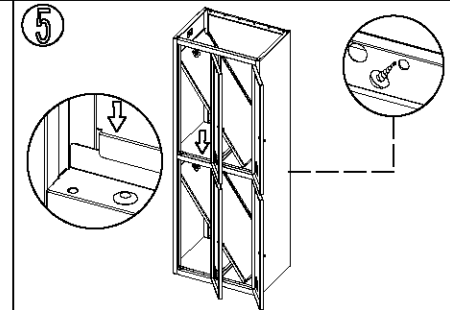

5 Install the middle plate firstly, and put the upper division plate into the locker.

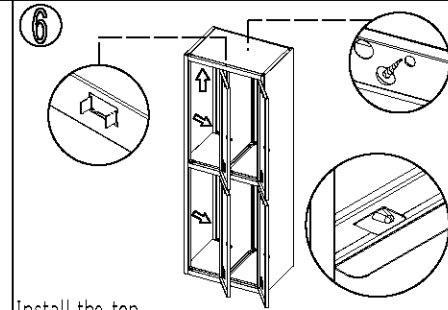

6 Install the top plate, and then install the upper and lower division plates as shown in the picture.

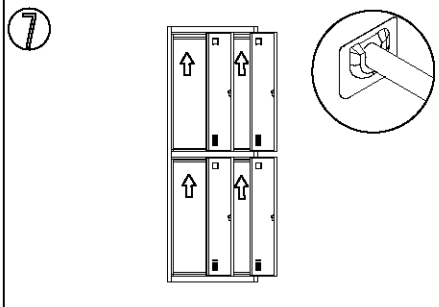

7 Install the hanging rods.

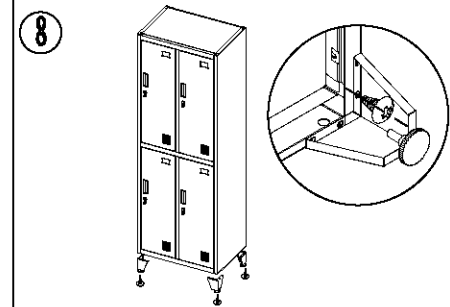

8 Install the standing feet with screws(5x12).



9 Adjust each part till fit well after installation.