

Left Side Plate:1 Pc

Right Side Plate:1 Pc

Door Frame:1 Pc

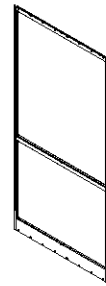

Back Plate:1 Pc

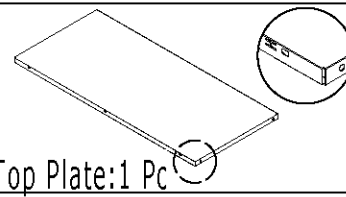

Top Plate:1 Pc

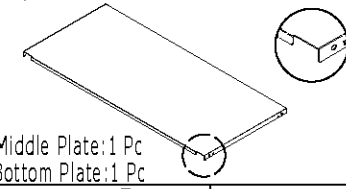

Middle Plate:1 Pc
Bottom Plate:1 Pc

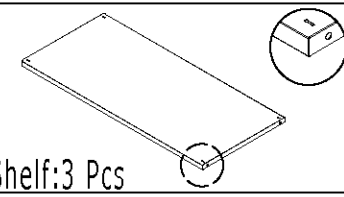

Shelf:3 Pcs

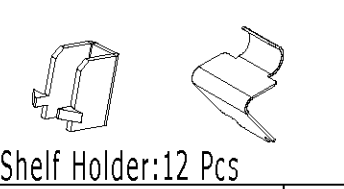

Shelf Holder:12 Pcs

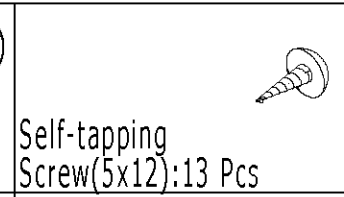

Self-tapping
Screw(5x12):13 Pcs

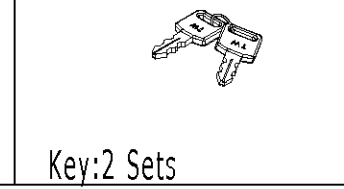

Key:2 Sets

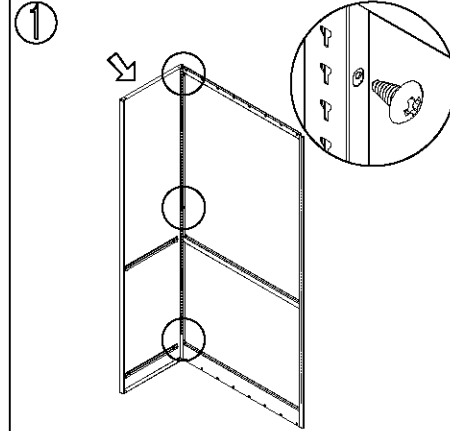
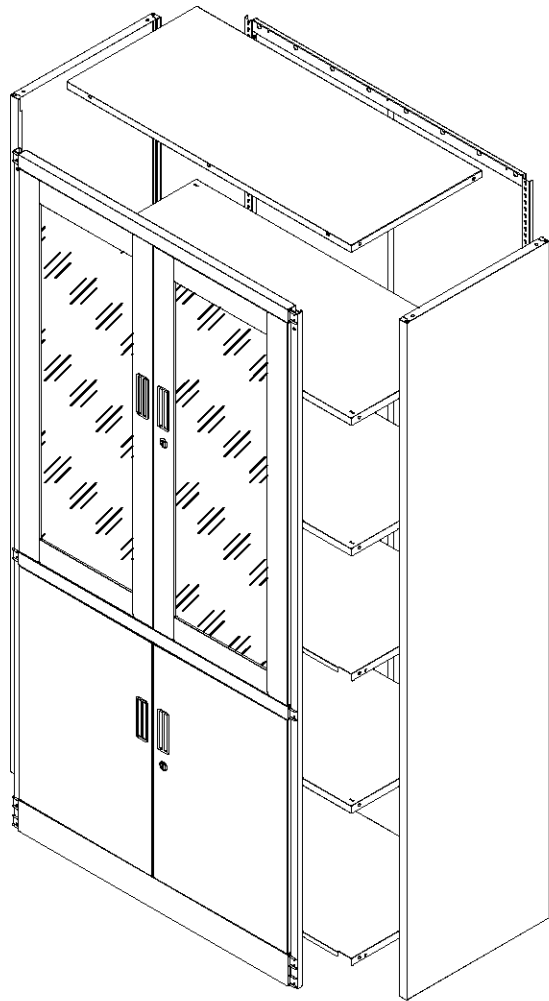

1 Connect the left side plate with back plate by self-tapping screws(5x12).

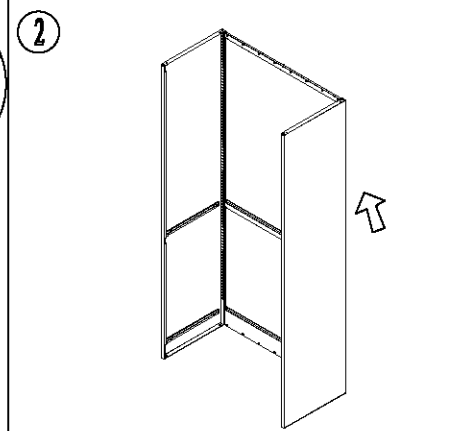

2 Connect the right side plate with back plate.

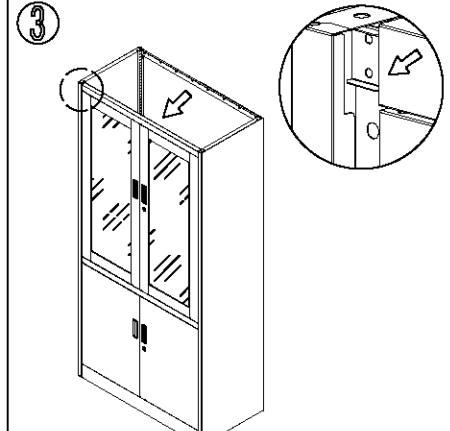

3 Fix the door frame onto both of the side plates.

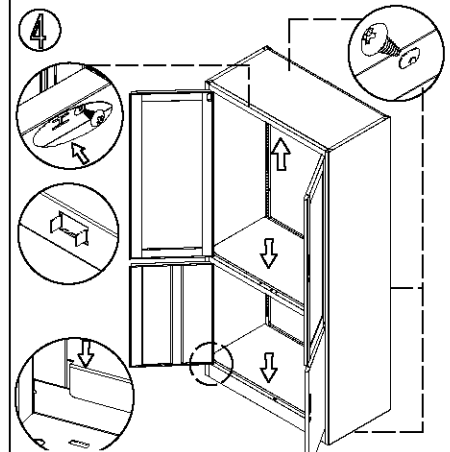

4 Install the top plate, bottom plate and middle plate with self-tapping screw 5*12.

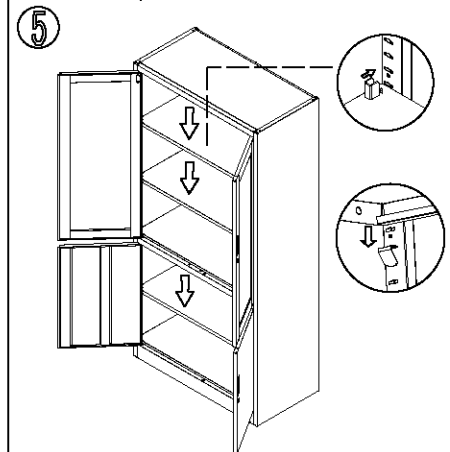

5 Install the shelves.

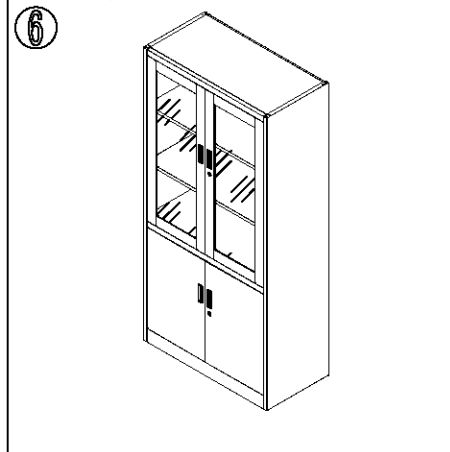

6 Adjust each parts till fit well after installation.