

1 Connect the left side plate with left back plate by self-tapping screws(5x12).

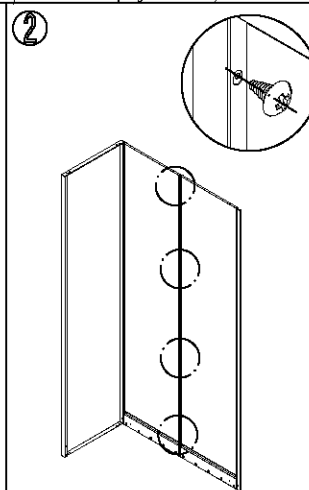

2 Connect the left back plate with right back plate.

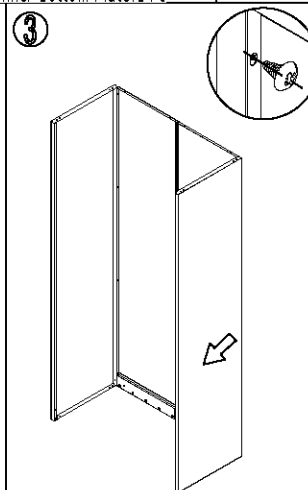

3 Connect the right side plate with right back plate.

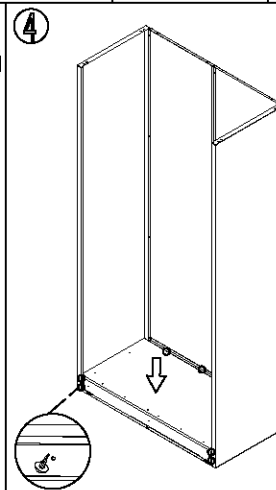

4 Install the bottom plate.

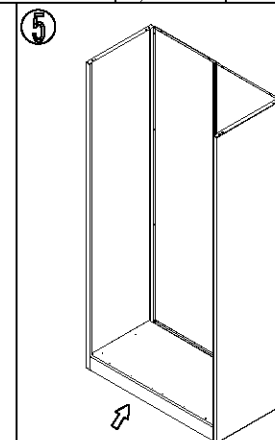

5 Install the outer bottom front panel as shown in the picture.

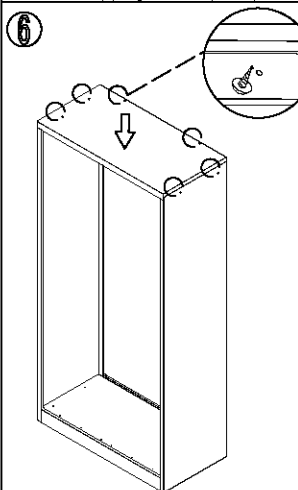

6 Install the top plate as shown in the picture.

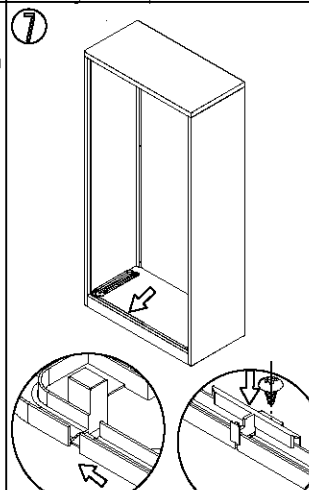

7 Install the lower slide rail onto the bottom plate.

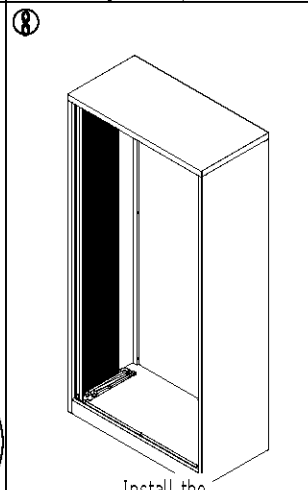

8 Install the shutter door, put the upper slide rail onto it, then fix them by screws.

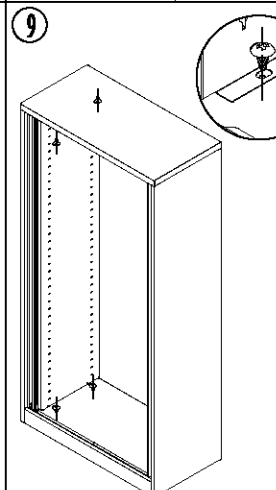

9 Connect the interlayer by self-tapping screws(5x12).

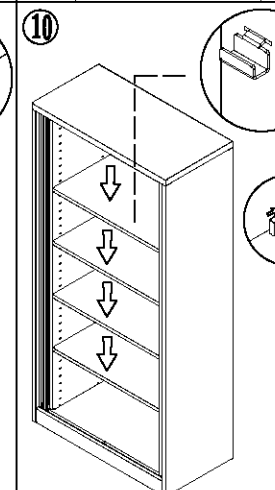

10 Install the shelves, and fit each part till fit well after installation.