

Self-tapping
Screw(5x12):15Pcs

Top Plate:1Pc

Shelf:4Pc

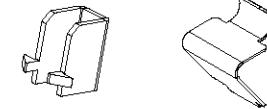
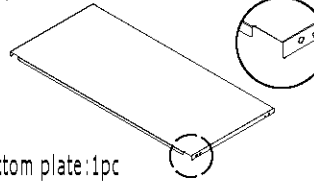

Key:1 Set

Left Side:1Pc

Right Side:1Pc

Door Frame:1Pc

Back Plate:1Pc

Bottom plate:1pc

Shelf Holder:16pcs

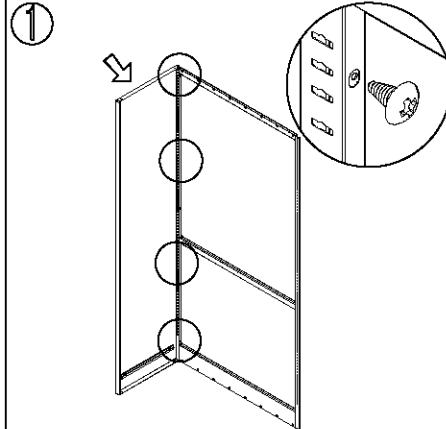
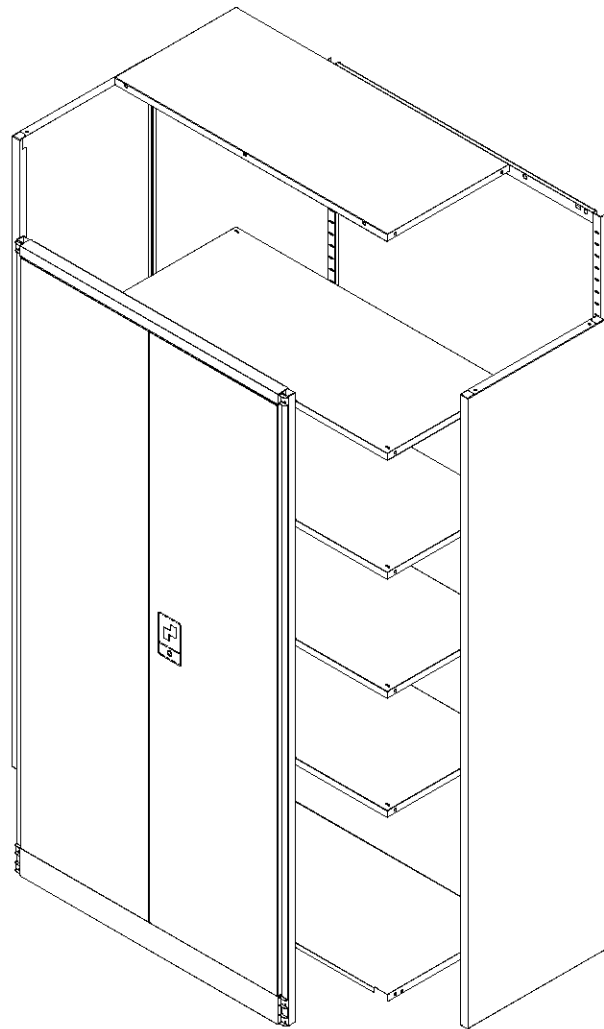

1 Bolt the left side and back plate with self-tapping screws(5x12)

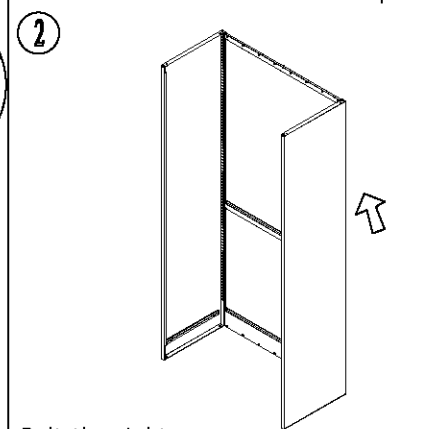

2 Bolt the right plate and back plate in the same way as the first step

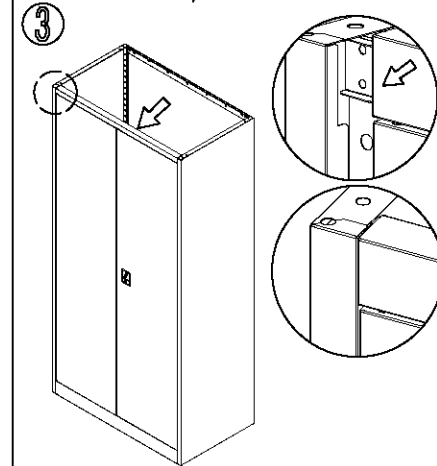

3 Fix the door frame onto both of the side plates

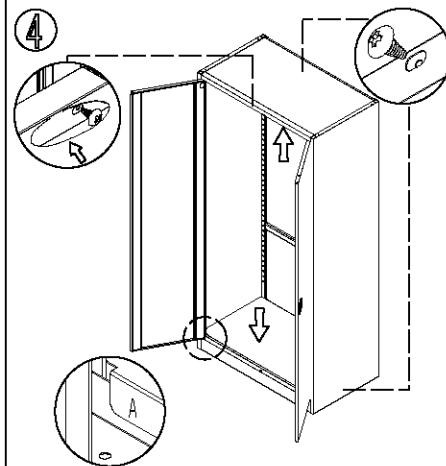

4 Install the top and bottom plate respectively

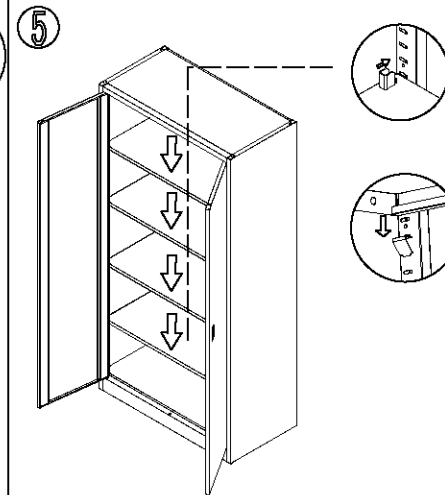

5 Install the shelves.

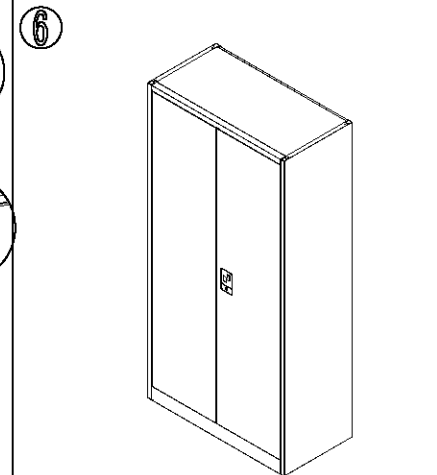

6 Adjust each parts till fit well after installation